

# Comfort Covering Application Instructions

Begin by removing the shoe protectors from the front of your Featherspring Foot Supports. Please make sure that your foot supports are clean and completely dry before you begin.

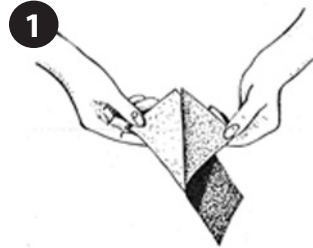

1. Peel the plastic backing from the Comfort Covering.

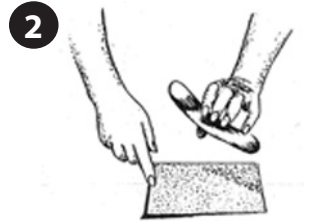

2. With the adhesive side facing up, lay the covering on a flat surface.

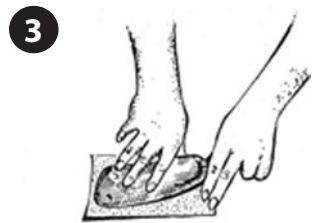

3. Place the front side of the Featherspring Foot Support on the adhesive.

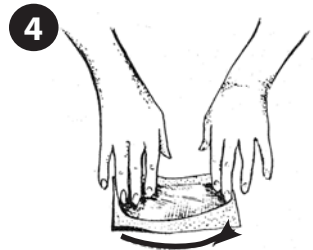

4. Using a rocking motion, roll the Featherspring down onto the adhesive until the covering is attached to the support.

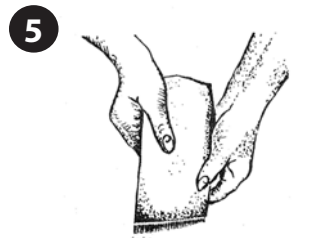

5. Using both thumbs, starting in the center of the support and working your way outwards, firmly smooth the covering onto the support. *If anything goes wrong, the covering can be removed without damaging the material or support. The covering can then be reapplied.*

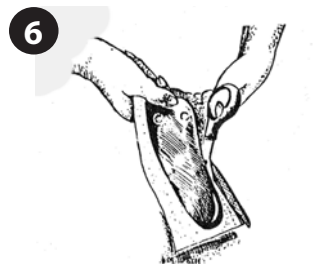

6. Cut the extra covering material away from the support with a pair of scissors (cut as close to the foot support as possible). Replace the shoe protectors and insert supports into your shoes.

When the covering wears out, it can be removed and new material applied by following the same procedures.

**If you have any questions or problems, please call us at 1-800-628-4693.**